

PLAT BOOK

OF

CLARK COUNTY
ILLINOIS

Published by

W.W.HIXSON & CO.

Rockford, Illinois

Quality :: Service :: Savings

Gasolines
Magic Aladdin
Kleer Motor
Green Rocket

Radiant Kerosene
T-40 Tractor Fuel
Penn Bond Oil
Blue Seal Oil
Blue Seal Grease

Blue Seal Tires
Blue Seal Batteries
Blue Seal Anti-Freeze
Blue Seal Fly Spray
Soyoil Paints

Gillette Tractor Tires
Soynamel and Varnish
Blue Seal Insecticides
Edison Spark Plugs

CLARK SERVICE CO.

MARSHALL
Phone 514

MARTINSVILLE
Phone 26

I. A. A. INSURANCE SERVICE....

A Policy to Fit Every Need

*Life - Automobile - Accident - Fire - Wind
Employer's Liability - Crop Hail Insurance*

LOW NET COST

RAYMOND LEE, General Agent

Phone 5085 or 26

MARTINSVILLE

CLARK COUNTY

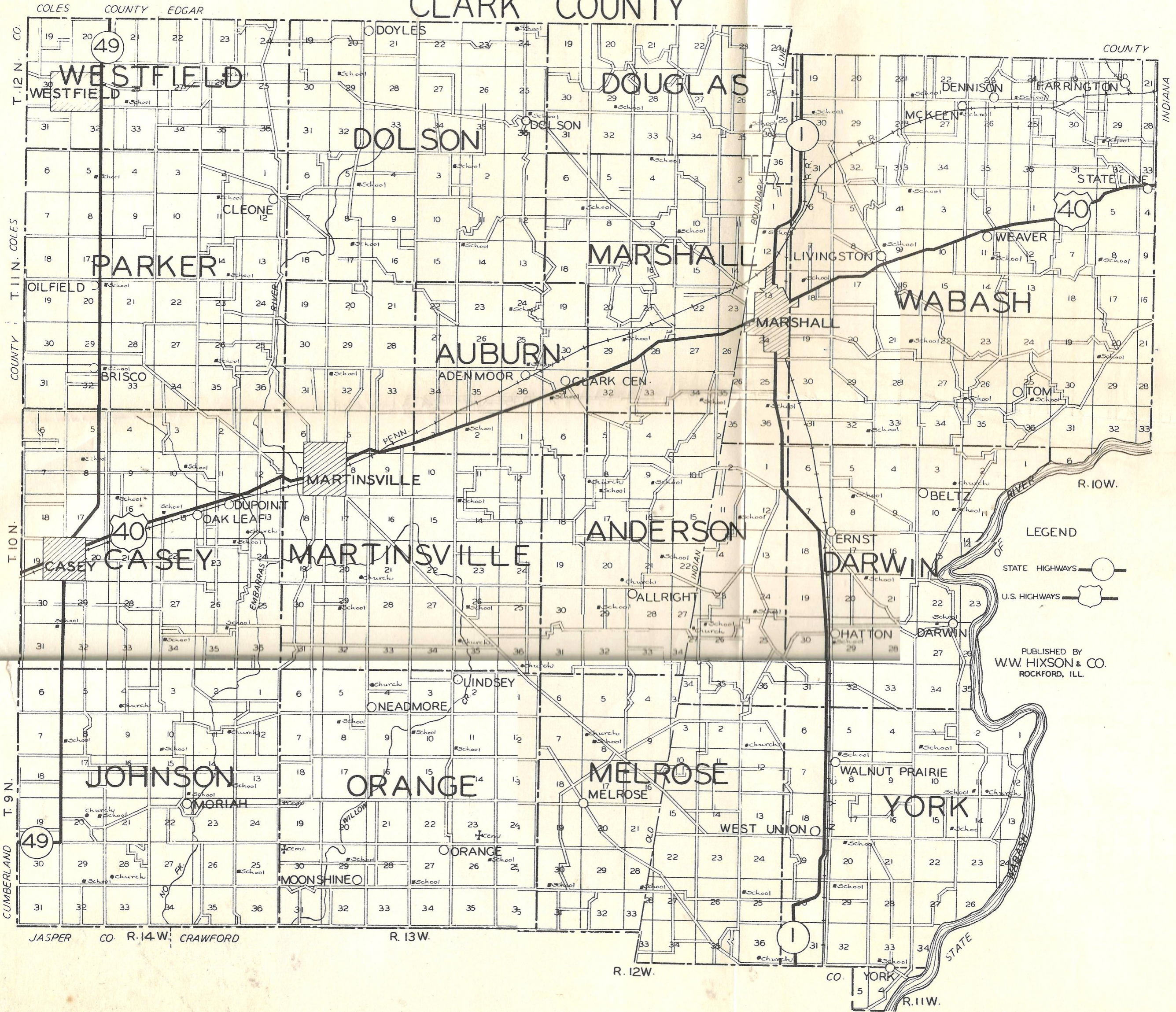

T.5N.

YORK

R.11W.

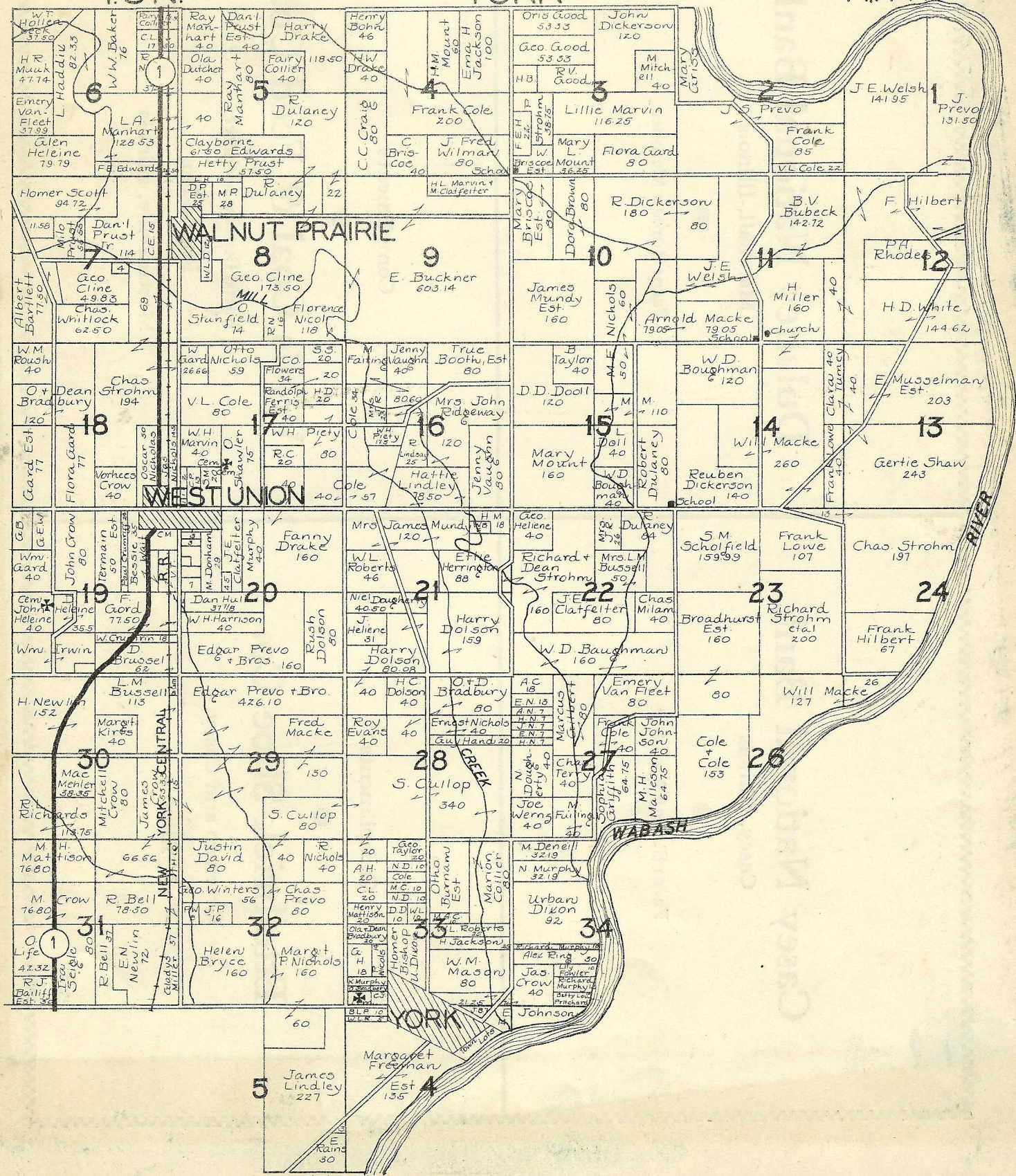

Casey National Bank

Casey, Illinois



Farm Bureau Member

Dulaney National Bank

Marshall, Illinois



Farm Bureau Member

Compliments



Ettelbrick Shoe Co.

Greenup and Casey,
Illinois

Compliments



Wells Coal & Feed Co.

Farm Bureau Member

Phone 216

Martinsville, Illinois

TION.

DARWIN

RIIW.

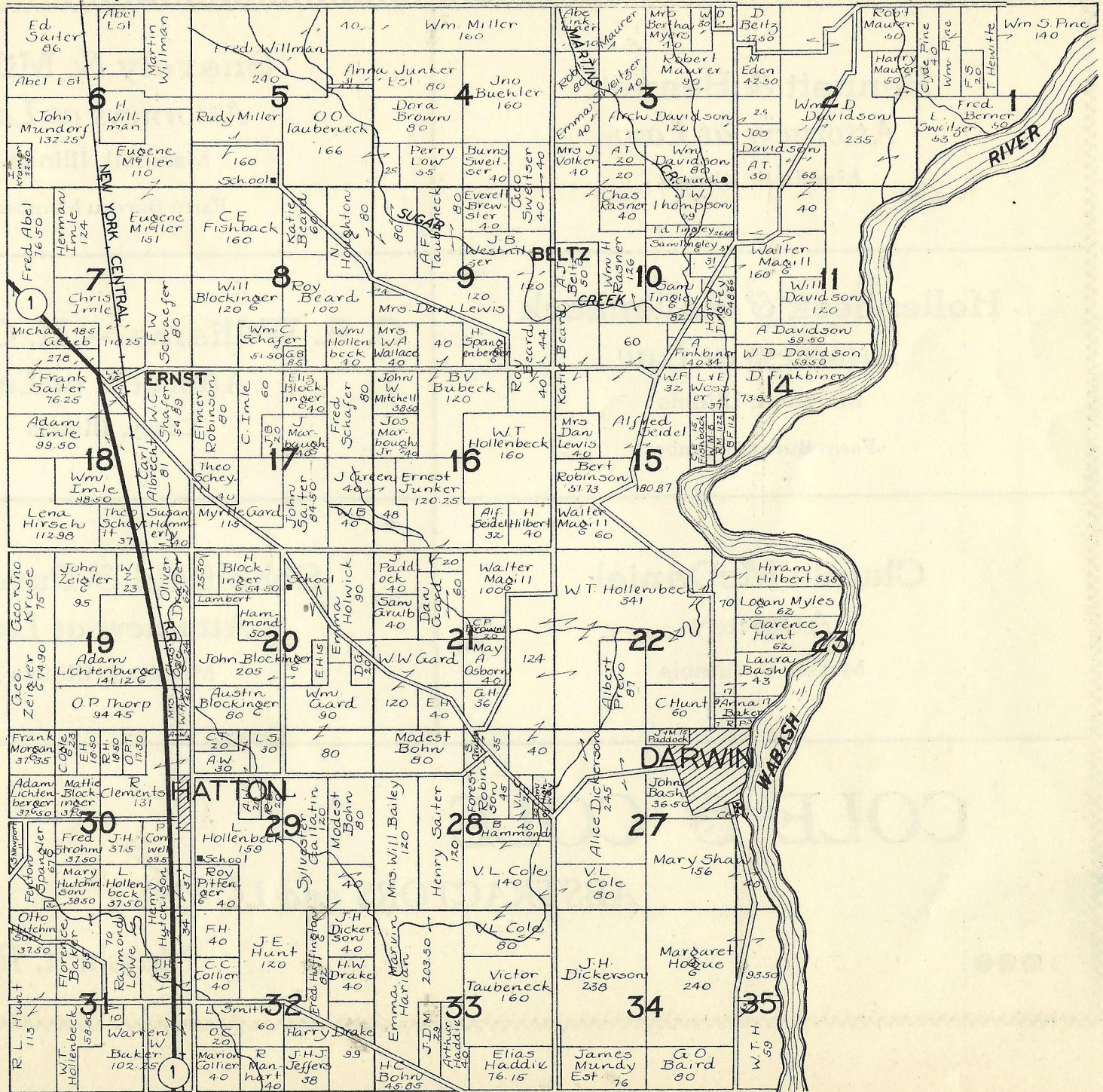

Bennett & Bennett
Attorneys at Law
Marshall, Illinois

Snavelly & Miller
Attorneys at Law
Marshall, Illinois
Farm Bureau Member

Hollenbeck & Hollenbeck
Attorneys at Law
Marshall, Illinois
Farm Bureau Member

C. A. Williams -- H. C. Partlow
Attorneys at Law
Casey, Illinois

Claude McDaniel
Attorney
Marshall, Illinois

Scholfield & Purdunn
Attorneys at Law
Marshall, Illinois

COLE & COLE

ABSTRACTORS and LOANS

Marshall, Illinois



T.10 & 11 N.

PART OF WABASH

R.10 & 11 W.

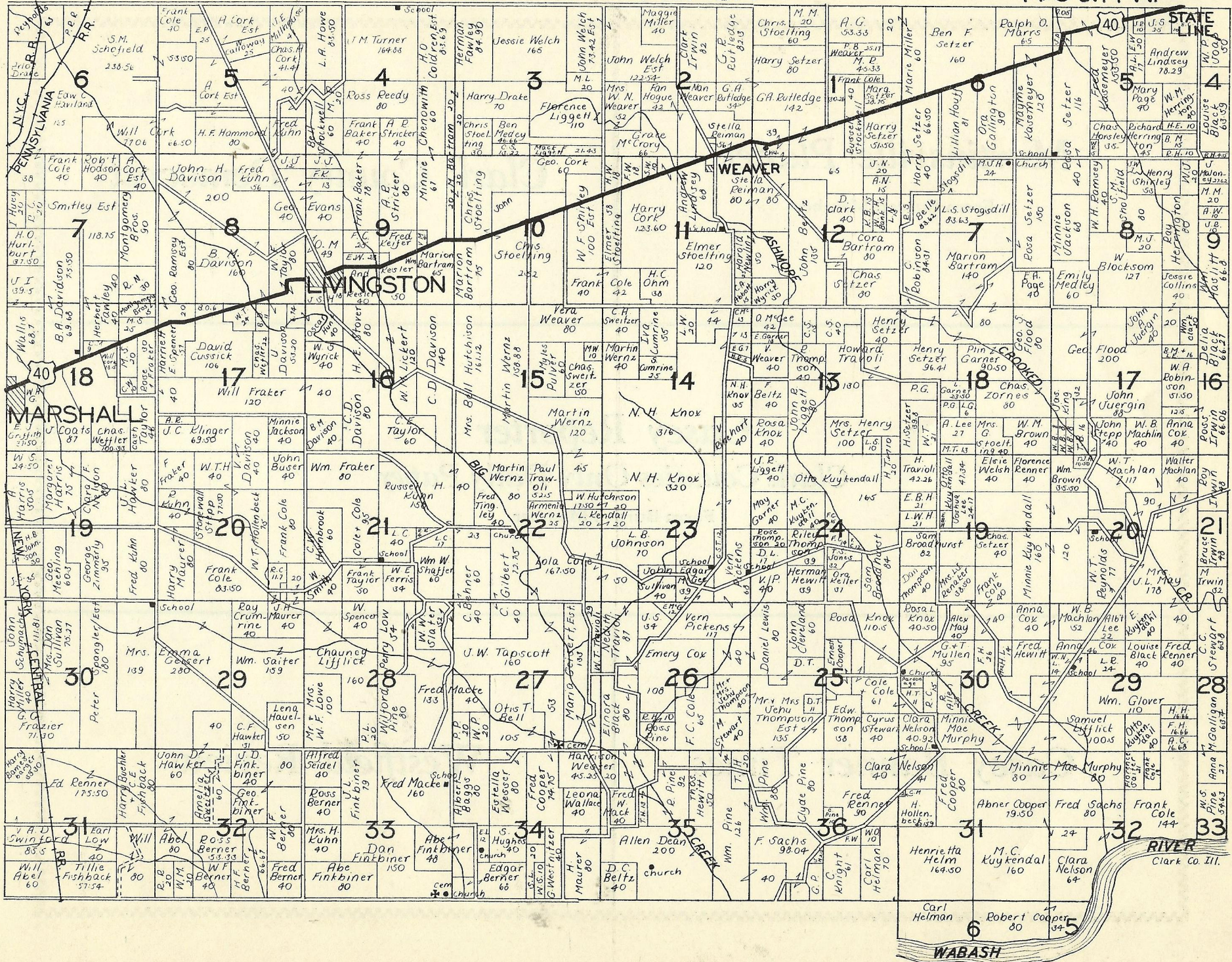

Martinsville Planet

Farm Bureau Member

Clark County Democrat

Casey Reporter

Clark Counties Only Daily Paper

Farm Bureau Member

Casey Banner Times

Westfield Review

T.12N.

PART OF WABASH

R.10 & 11 W.

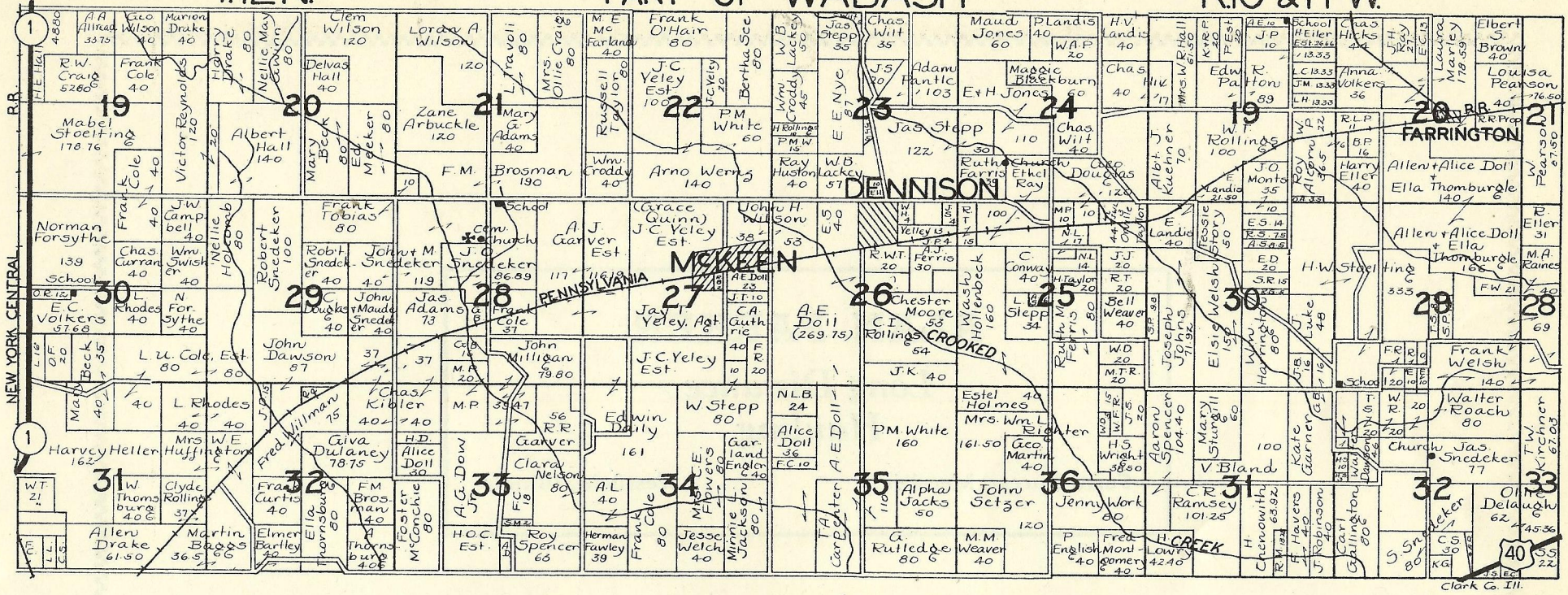

ALAN PARKER

*Long Distance
Hauling*

Farm Bureau Member

Westfield, Illinois

M. E. WOODARD

*Long Distance
Hauling*

Farm Bureau Member

Westfield, Illinois

T.9N.

MELROSE

R.12W.

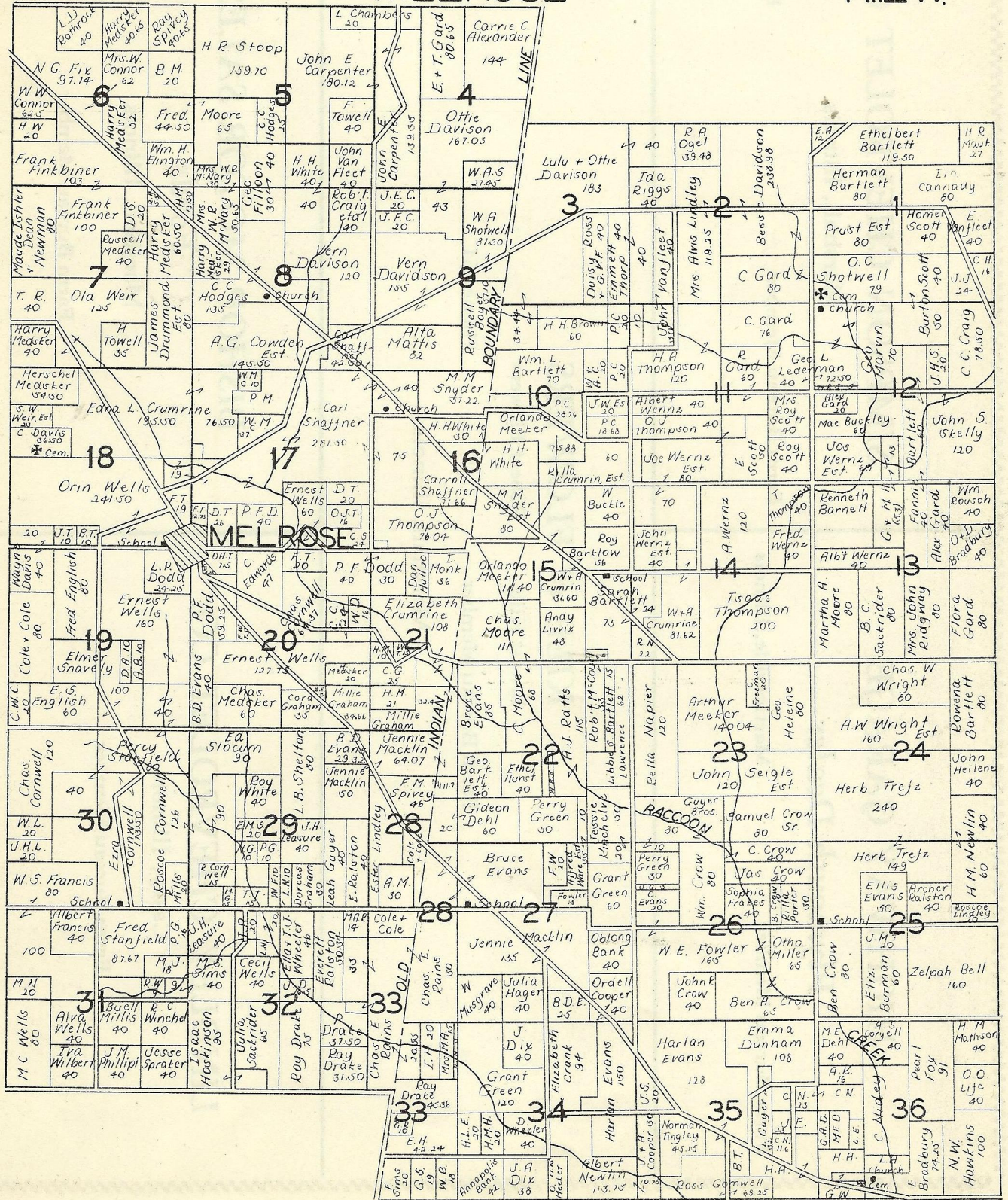

HIGHWAY GARAGE

Plymouth Dealer

Farm Bureau Member

Martinsville, Illinois

SIMPSON CHEVROLET CO.

Marshall, Illinois

Farm Bureau Member

Phone 345

KILE & FLOWERS

Ernest Kile

Robert Flowers

Farm Bureau Member

::

Phone 464

Marshall, Illinois

LINDLEY CHEVROLET CO.

Casey, Illinois

Farm Bureau Member

BISHOP MOTOR SALES

Fords

Marshall, Illinois

Farm Bureau Member

STRICKLETT HARDWARE

Martinsville, Ill.



Farm Bureau Member

ROLLA BURGER

Hardware

Martinsville :: Illinois

JONES HARDWARE

Everything in Hardware

Casey, Ill.



Farm Bureau Member

Facilities for Processing Meats, Fruits and
Vegetables



LOCKER STORAGE AVAILABLE



Phone 318

SPOTTS LOCKER SERVICE

Marshall, Illinois

BUBECK & GALLAGHER
FUNERAL DIRECTORS

and
Home Furnishings

RADIOS, REFRIGERATORS, STOVES

AMBULANCE DAY AND NIGHT

Farm Bureau Member

::

Marshall, Illinois

JOHNSON FUNERAL HOME

THOUGHTFUL SERVICE

Phone 37

::

Martinsville, Ill.

Farm Bureau Member

Lee S. Greenwell

Funeral Director

Martinsville :: Illinois

Swinford Funeral Home

Casey, Illinois

Farm Bureau Member

T.12N.

DOUGLAS

R.12W.

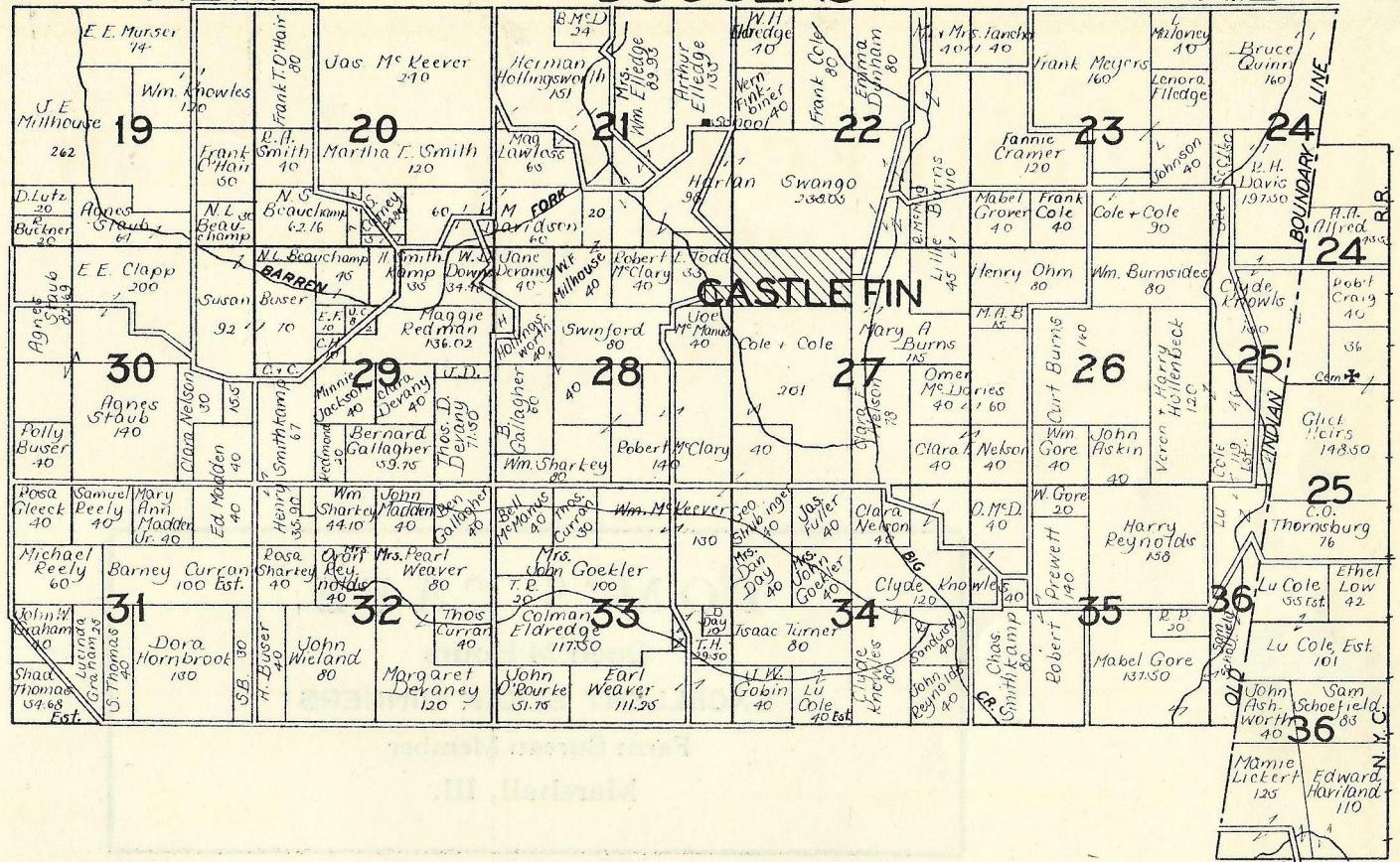

Clark Co. Ill.

TOM'S CAFE

Open 24 Hours

EXCELLENT STEAK DINNERS

Farm Bureau Member

Marshall, Ill.

T.9N.

ORANGE

R.13W.

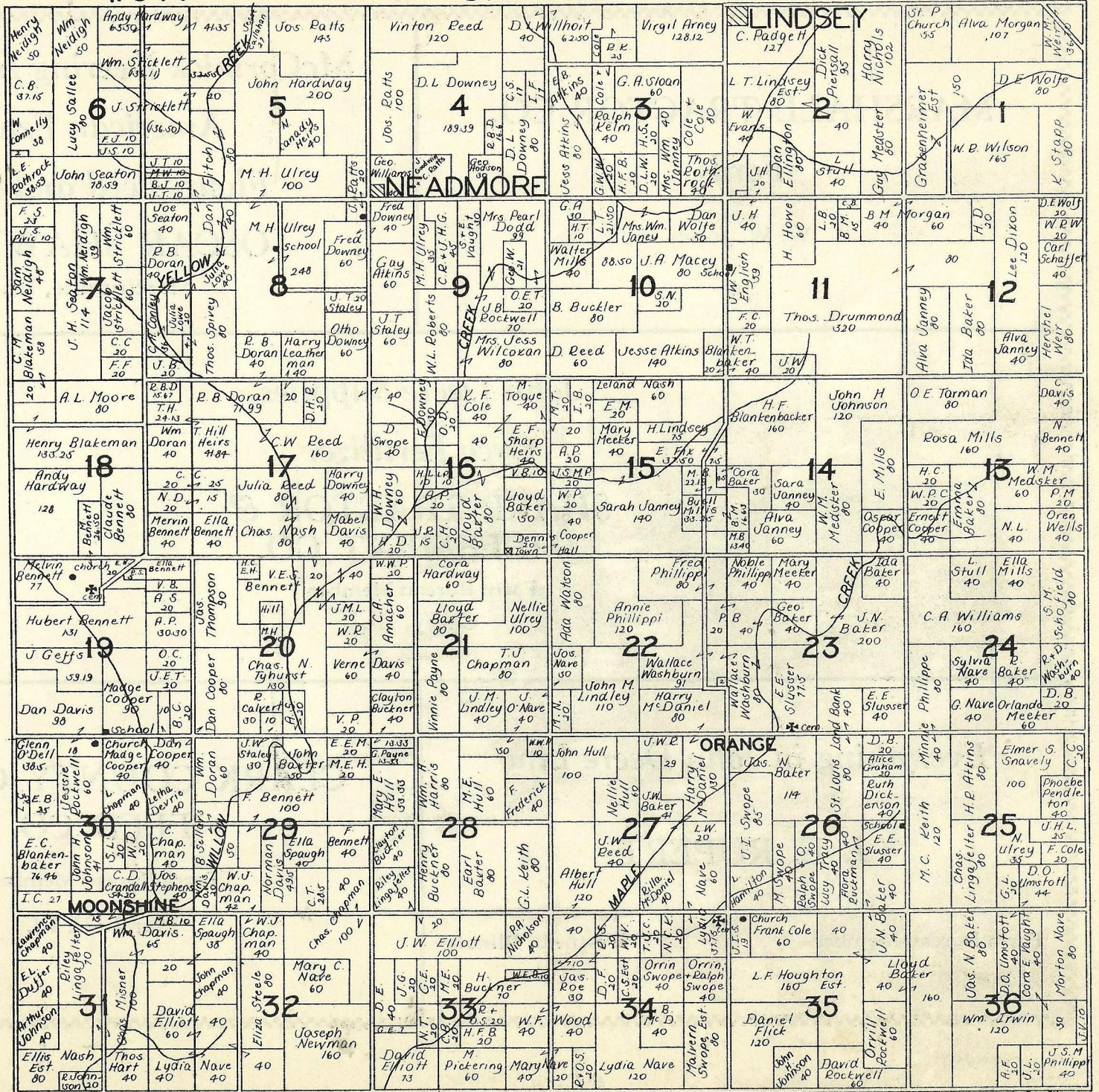

MARSHALL TRACTOR CO.

Fords

W. W. Jones

McCormick Deering Implements

American Fence

Flour, Feed and Coal

OSCAR SHAWVER

Martinsville, Ill.

John Deere Supplies

Cyco Fertilizer

**SHARP TRACTOR &
IMPLEMENT CO.**

Farm Bureau Member

Casey, Ill.

Everything in John Deere Line

J. E. RUPERT

Farm Bureau Member

Westfield, Illinois

**CLARK COUNTY COAL &
FEED CO.**

Farm Bureau Member

Marshall, Ill.

T.10N. PART OF MARTINSVILLE R13W

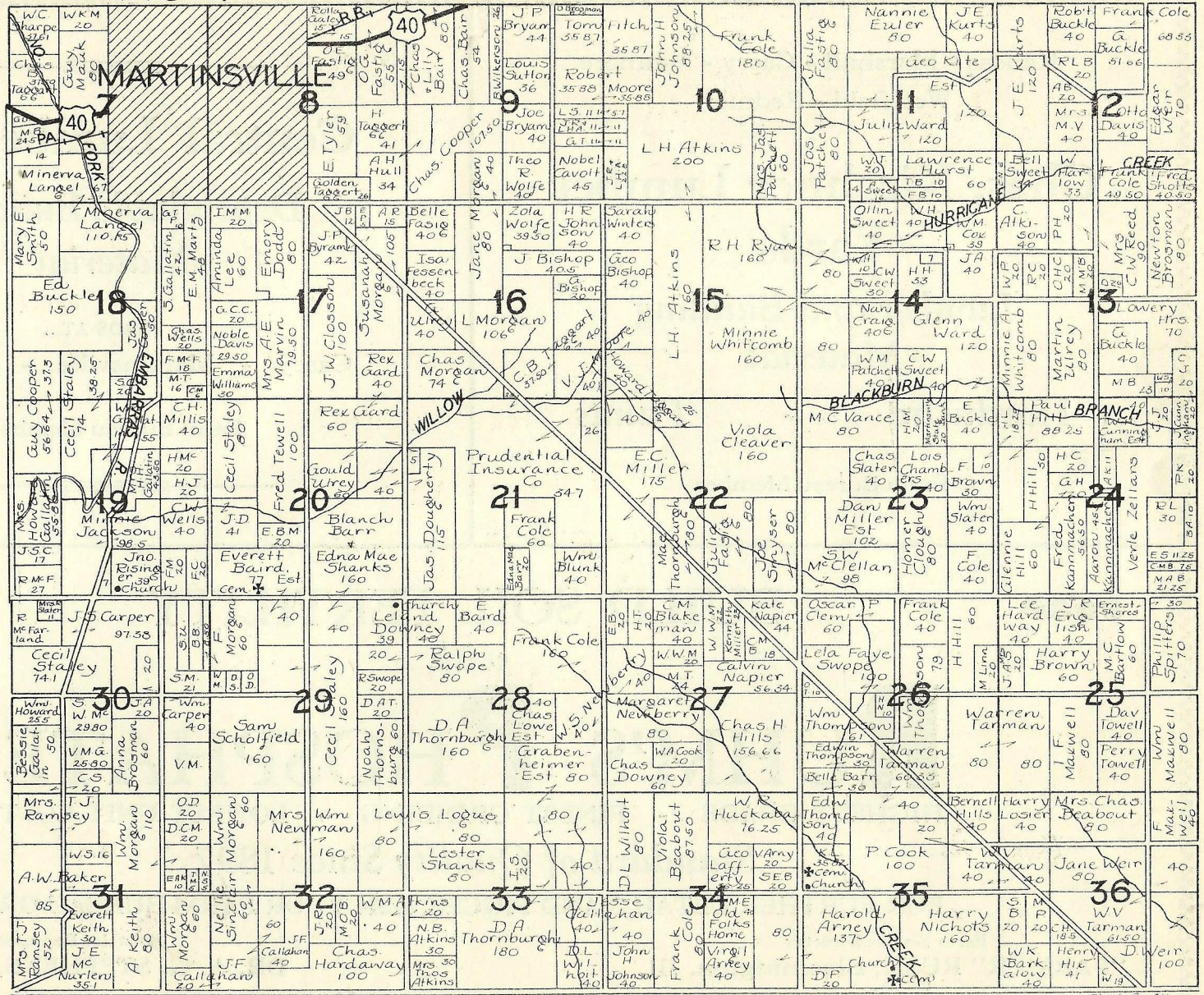

Kansas - Marshall - Casey - Ashmore
Westfield - Redmon

**Chas. Kirchner Lumber
Yards**

*Lumber and Building
Material*

Hardware - Paints

Farm Bureau Member

Central Lumber Co.

*Dependable Building
Material*

...YARDS AT...

Casey - Martinsville - Marshall

Farm Bureau Member

●●●● BUILD SOIL FERTILITY ●●●●

with

RUHM'S PHOSPHATE

HIGHEST GRADE - FINEST GRINDING - LOWEST UNIT COST

Standard of Quality Since 1897

FOR FURTHER DETAILS AND PRICES, ASK YOUR FARM BUREAU OR

Farm Service Director

"FARMER" RUSK, Bloomington, Ill.

District Representative

DR. A. G. STEPHENS, Westfield, Ill.

SOIL TESTS FREE

RUHM PHOSPHATE & CHEMICAL CO., Mt. Pleasant, Tenn.

T.10 & 11N.

AUBURN & PART OF MARTINSVILLE

R12 & 13W.

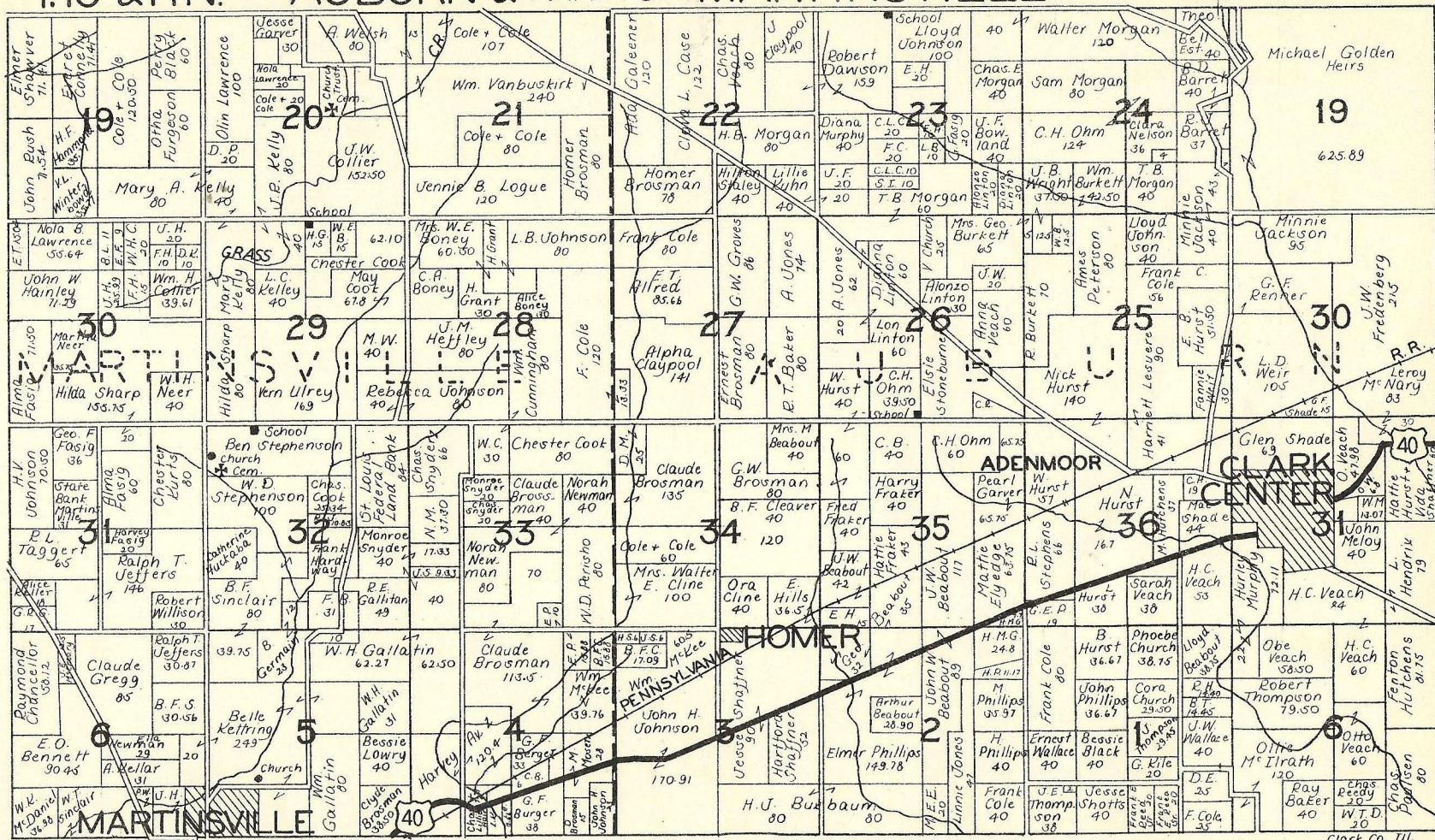

Clark Co. Ill.

T.11 & 12N.

DOLSON

R.13W.

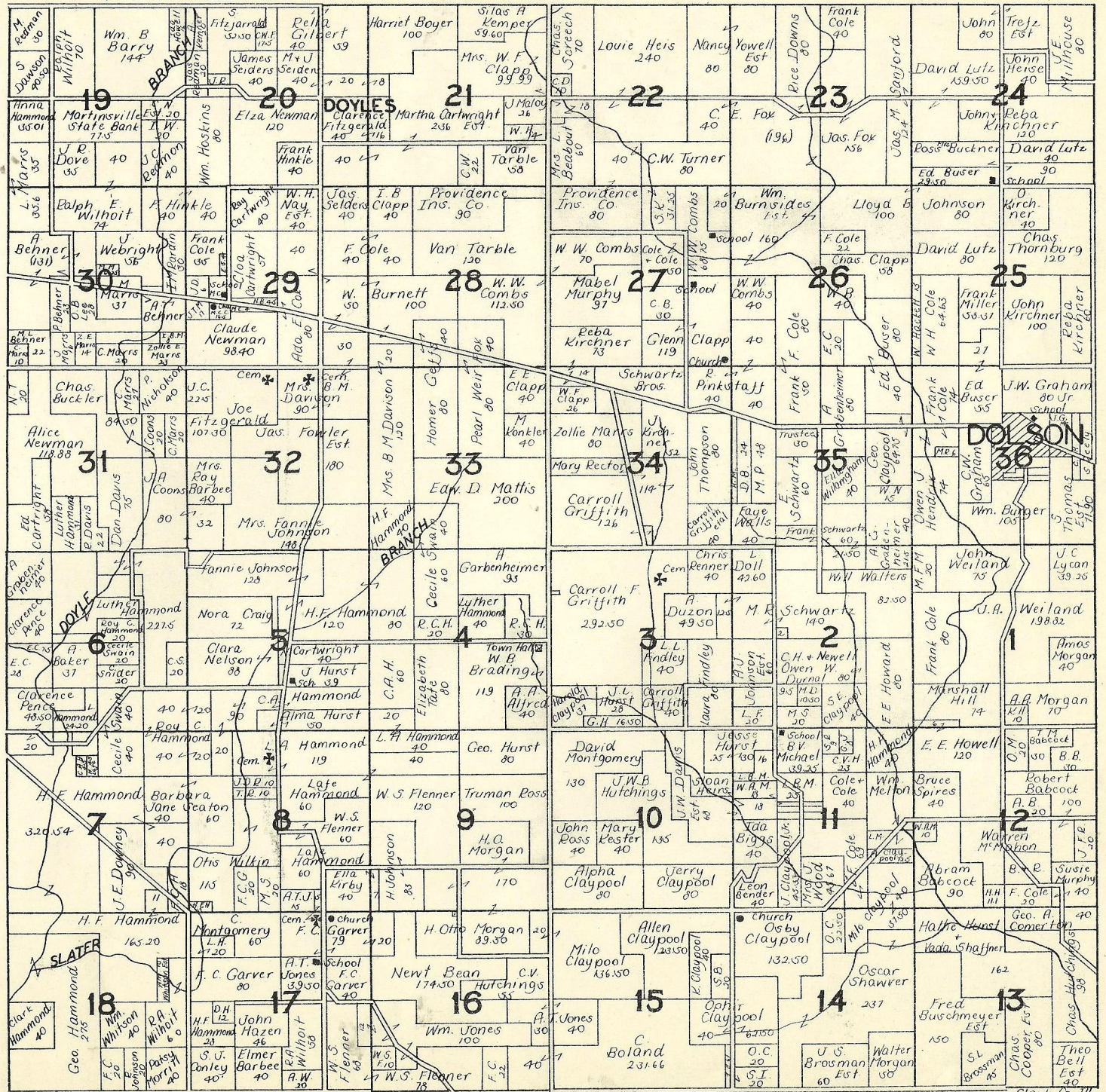

T.9N.

JOHNSON

R.14W.

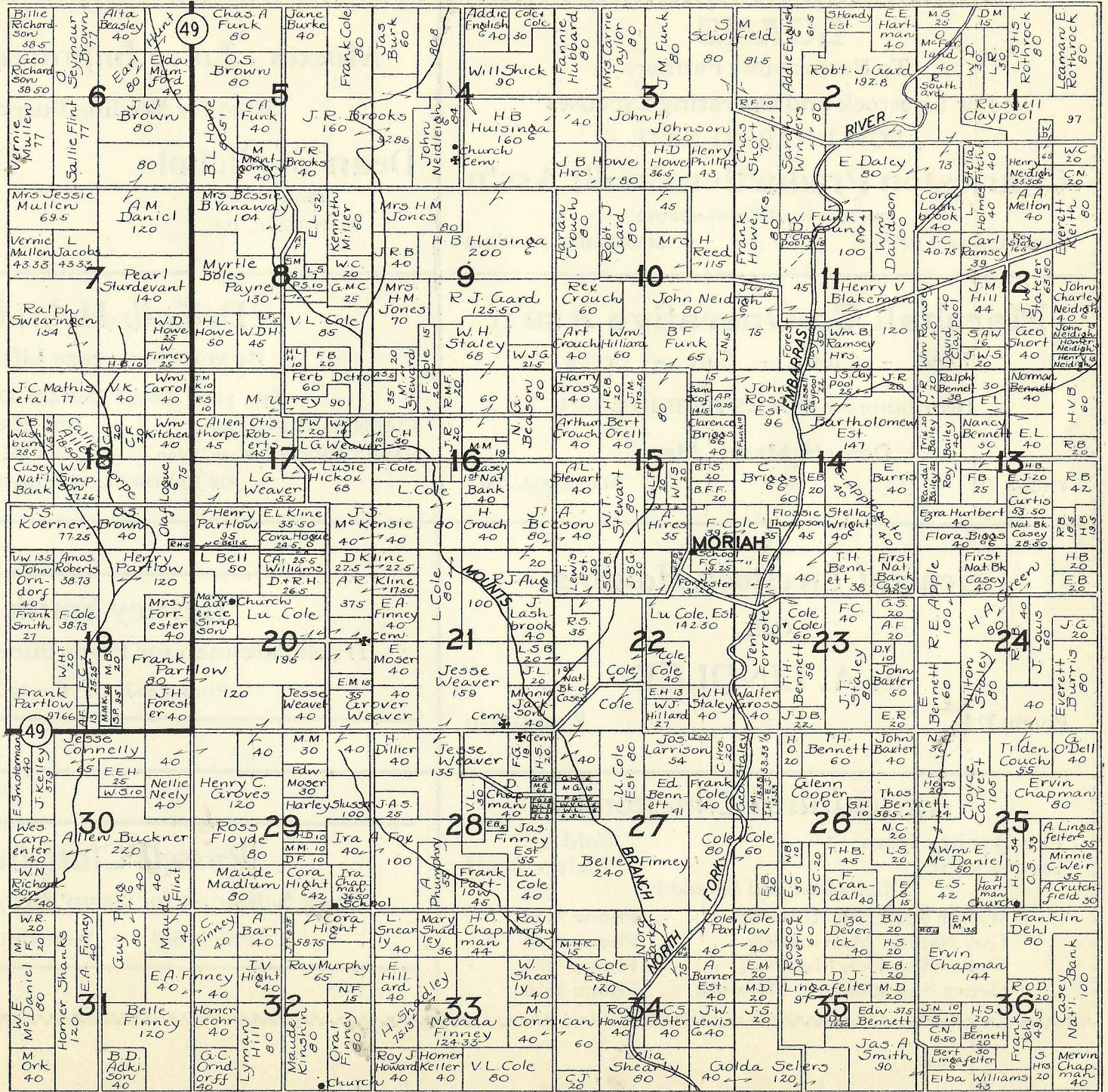

LOANS

To Responsible Farmers

For Livestock and Operating Expenses

LOW INTEREST RATE

Charleston Production Credit Ass'n

See Your Local Representative

FARM BUREAU OFFICE

::

MARSHALL, ILLINOIS

Moews - Lowe Improved Hybrids

Bred for Feeding Purposes

Dean C. Nichols

Phone 8328

MARSHALL, ILL.

D. E. Kelley

Phone 7918

MARTINSVILLE, ILL.

Marshall Co-Operative Ass'n

Feed - Flour - Salt - Seeds

Distributors of FUNKS HYBRID CORN

Demain Macey, Mgr.

PHONE 341

::

MARSHALL, ILL.

DeKalb Hybrids

Be your Mortgage Lifter

See your Local DeKalb Dealer

GLENN HAWKINS, Casey

WALTER BROWN, Casey

HARRY WRIGHT, West Union

LEANDER WRIGHT, Marshall

JOE HARDWAY, Martinsville

General Livestock Hauling

Call

R. A. LINDLEY

Phone 214

::

West Union

Barney Smith

Truck Salesman for Farm Bureau Products

Phone 863 :: Casey

Agricultural Limestone

The Quality from
Tarble's Pit

Sold by:
Walter Scott

Delivered and Spread by

Walter Scott, Martinsville . . . Phone 7433

Guy Napier, Martinsville . . . Phone 6144

Walter Sanders, Marshall . . . Phone 379

Henry Spangenberg, Marshall . . . Phone 8566

Russell Clatfelter

Truck Salesman for Farm Bureau Products

Phone 503 :: West Union

TION.

CASEY

RI4W.

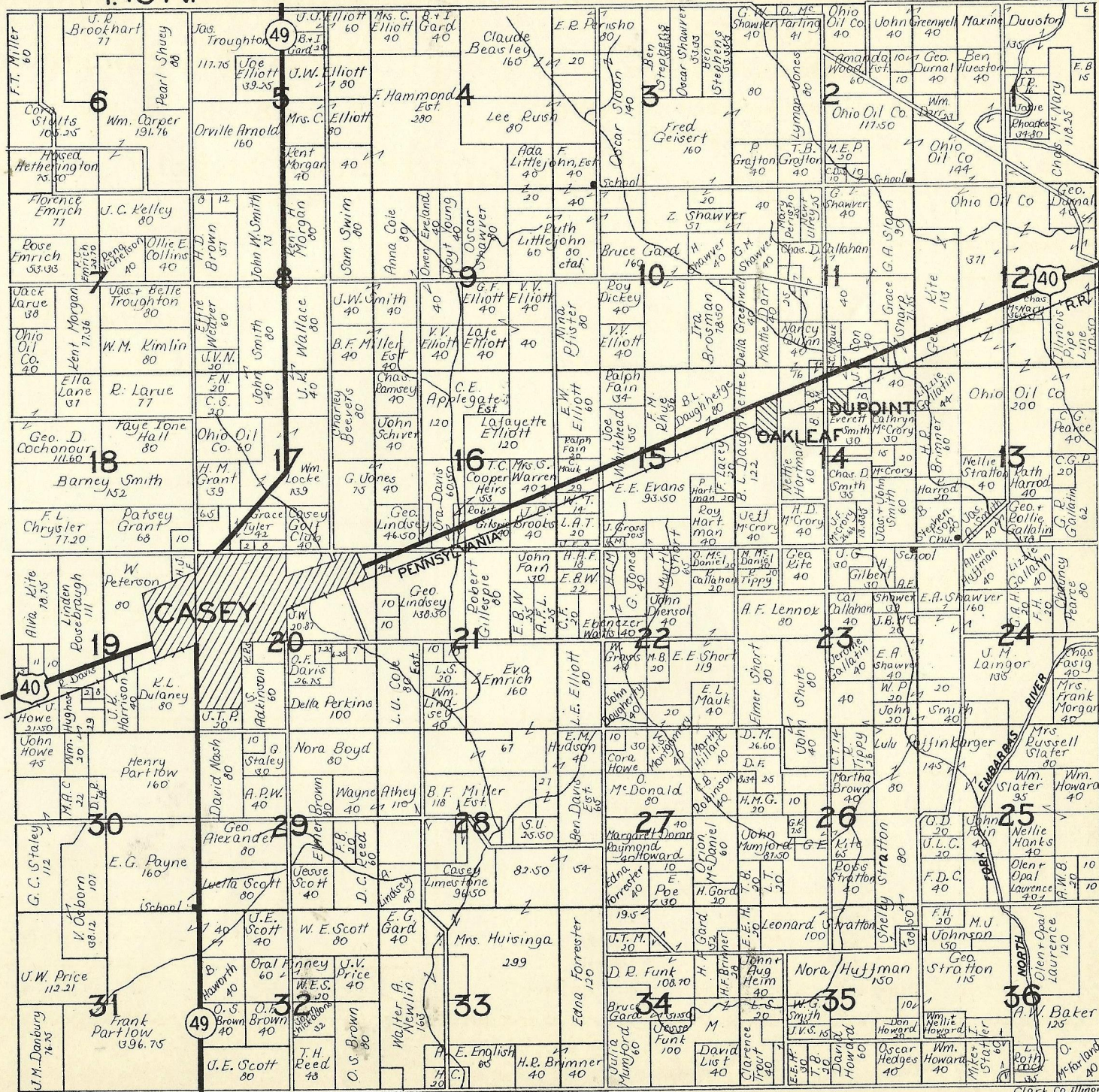

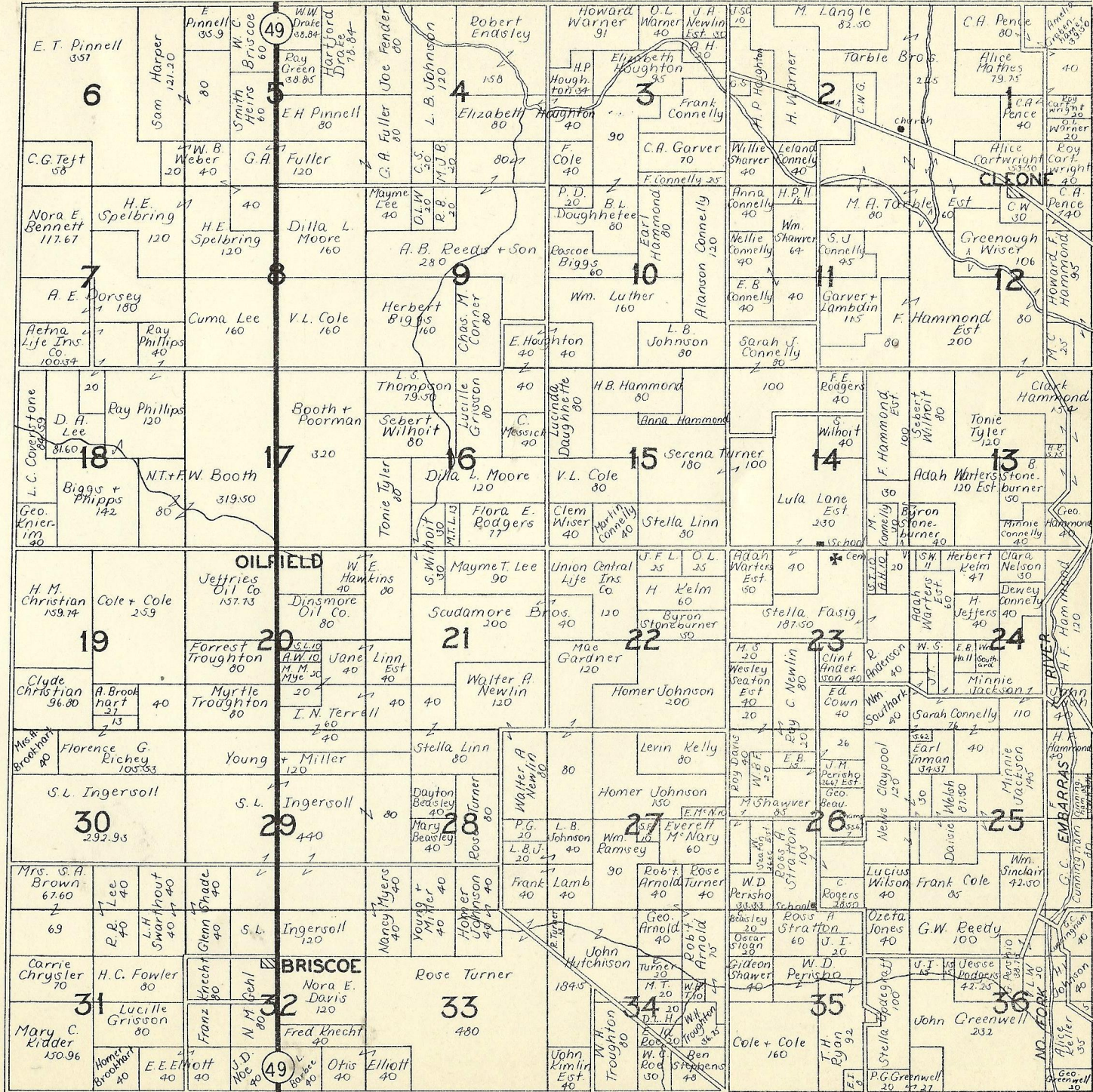

T.12N.

WESTFIELD

R.14W.

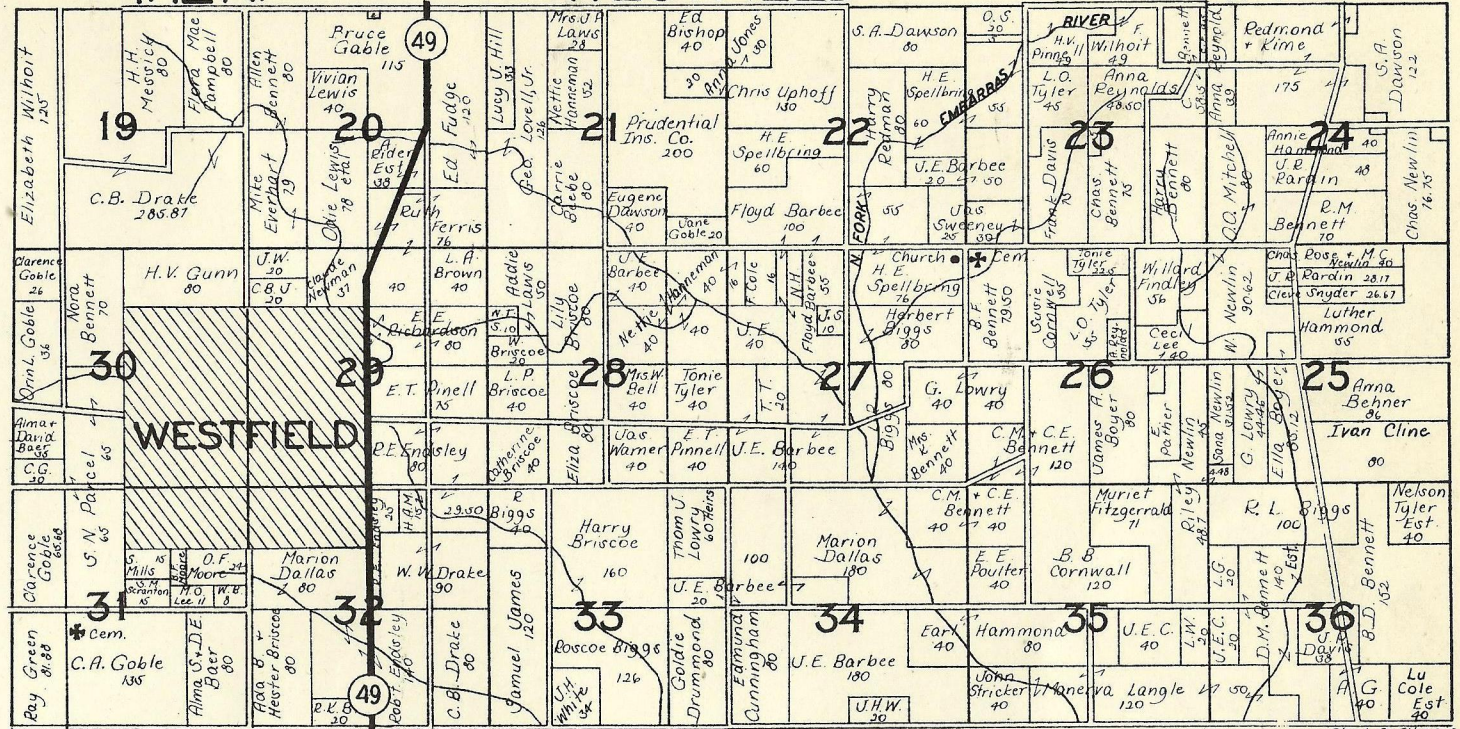

Casey Lime & Stone Co.

Farm Bureau Member

Montgomery Bros.

Rock Crusher
Quality Lime

Phone 5082

Marshall :: Illinois

Farm Bureau Member

Quality Lime Company

●
Agricultural Limestone
Crushed Stone

●
Van Tarble :: Marshall, Ill.

A & E Stone Co.

“Ag. Lime” -- “Crushed Stone”

Phone 855

Casey :: Illinois

CLARK COUNTY FARM BUREAU

ONE MAN ALONE WILL NOT

1. Be able to dictate farm legislation that is so essential to agriculture.
 2. Be able to secure a more just portion for farmers of the Nation's annual income and correct situation wherein farmers making up 25% of the people of the United States and owning 21% of the wealth, receive less than 10% of the Nation's annual income.
 3. Be able to increase farmers patronage and co-operative business so as to continue to make quality merchandise available at economical prices.
 4. Be able to work effectively for a happier and more prosperous farm life.
-

This is But Part of Your Farm Bureau's Program.

If we want to get
these jobs Done

Let's ^{GO}_{IT} Together

Join the Clark County
Farm Bureau Today!